

Possible applications include :



Sliding gate



Features

- Aluminum bracket and plate Zinc-plated steel roller Load capacity per roller 200 Kg With corrosion-resistant screws (Géomet®)



Tip

- The fixing plate (see diagram) is compatible with this roller. Complies with the NF EN13241-1 standard.

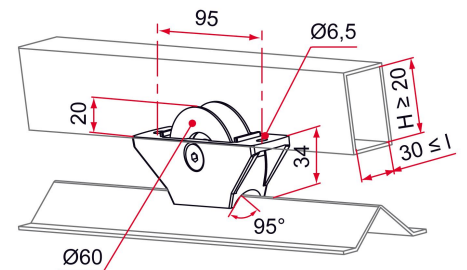

Compatible avec cette plaque de fixation

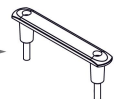

Products to be ordered from :
 TIRARD SAS 16, Avenue du Vimeu Vert Z.A. du Vimeu Industriel 80210
 FEUQUIERES-EN-VIMEU
 email : commande@tirard-burgaud.com

Possible applications include :



Sliding gate



Référence	Wheel material	Finish	GENCOD 3661598	Condit. par	Délai j
NN192055	steel	9005-80%	04407 3	1	14
NN191055	steel	9016-80%	04406 6	1	14
NN1XX055	steel		04415 8	1	21

 Multi-RAL : specify your color when placing the order (<https://www.couleursral.fr/ral-classic>)